



RAYNERS
TOWN & COUNTRY

BOURNE VIEW
KENLEY

2 BOURNE VIEW

KENLEY, SURREY, CR8 5AD

No. 2 Bourne View is a detached two bedroom character bungalow. Inside, the property features a spacious and welcoming living room with bay window. There is a gally kitchen and additional utility area outside. Bedroom 1 also has a lovely feature bay window and the second bedroom looks out onto the garden. There is a family bathroom. Outside the property there is a large spacious level rear garden with a recently paved patio and BBQ area. The rest of this easy to maintain garden is mainly laid to lawn and features a large workshop with power.

The bungalow sits on a large level plot with parking for several cars and offers significant potential to extend upwards or outwards (subject to planning permission).





Tenure: Freehold **Local Authority:** Croydon District Council **EPC Rating:** TBC

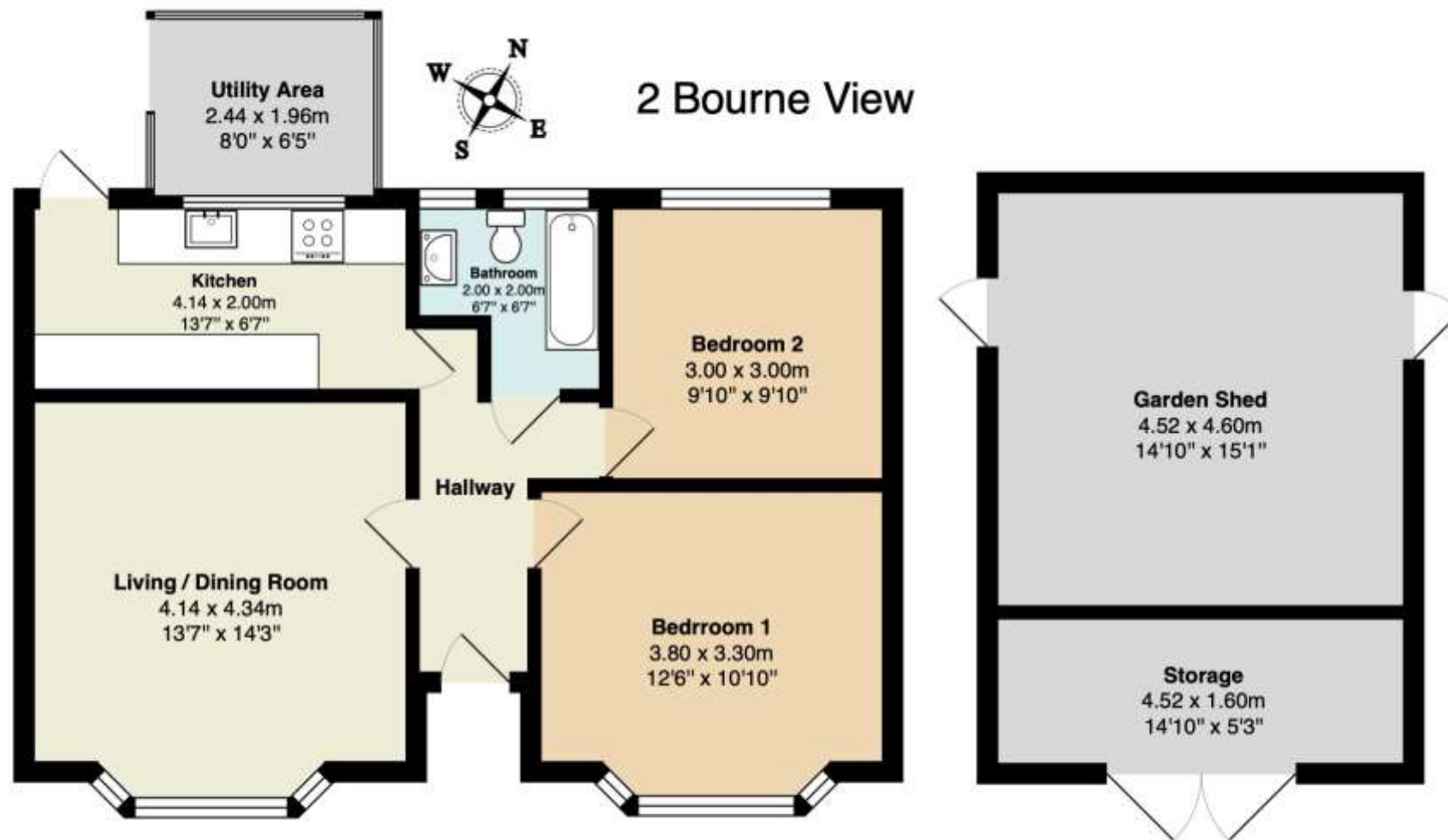

VIEWING STRICTLY BY APPOINTMENT VIA THE SELLING AGENT

www.raynersproperties.com

IMPORTANT: we would like to inform prospective purchasers that these sales particulars have been prepared as a general guide only. A detailed survey has not been carried out, nor the services, appliances and fittings tested. Room sizes should not be relied upon for furnishing purposes and are approximate. If floor plans are included, they are for guidance only and illustration purposes only and may not be to scale. If there are any important matters likely to affect your decision to buy, please contact us before viewing the property. R772

Caterham
01883 347 446
caterham@raynersproperties.com

Godstone
01883 744 344
godstone@raynersproperties.com

Warlingham
01883 622 258
warlingham@raynerspropepties.com

Lettings
01883 622 244
lettings@raynersproperties.com

Land & New Homes
01883 744 344
lnh@raynersproperties.com

RAYNERS
TOWN & COUNTRY